

Coos County Planning Department

Coos County Courthouse Annex, Coquille, Oregon 97423

Mailing Address: Planning Department, Coos County Courthouse, Coquille, Oregon 97423

(541) 396-3121 Ext.210

FAX (541) 396-2690 / TDD (800) 735-2900

RECEIVED

MAY 27 2008

PERKINS OFF

REVISED NOTICE OF PLANNING DIRECTOR'S DECISION

You have received this notice regarding decisions on the following land use applications because you are either an adjacent property owner, affected city, special district, hearings body member, or person who requested notice. Notice of these decisions was previously mailed to some parties on May 9, 2008. This revised notice is being mailed on May 23, 2008, to ensure that all necessary parties receive notice. The 15-day appeal period has been adjusted accordingly. The location of the property is shown on the attached vicinity map.

NOTICE IS HEREBY GIVEN that the Coos County Planning Director rendered the following decision(s) on MAY 9, 2008;

ITEM 1: APPROVED*, File# ACU-08-10 - A request for an administrative conditional use (ACU) to allow storage/sorting of sand in the Coos Bay Estuary Management Plan (CBEMP) segments 3-Water-Dependent Development Shorelands (3-WD) and 3-Non-Water-Dependent Shorelands (3-NWD). The subject property is identified as Township 25, Range 13, Section(s) 18, Tax lots 100 and 201. The applicant is Jeff Bishop, Executive Director, Oregon International Port of Coos Bay. The application meets the applicable criteria set forth in the Coos County Zoning and Land Development Ordinance (CCZLDO) Sections 4.5.241 Uses, Activities and Special Conditions in the 3-WD segment of the CBEMP and 4.5.242.02 Uses, Activities and Special Conditions in the 3-NWD segment of the CBEMP. The property is located west of the City of Coos Bay. The property is zoned Coos Bay Estuary Management Plan (CBEMP) 3-WD and 3-NWD, and contains approximately 206 acres.

ITEM 2: APPROVED*, File# CL-08-01 - Request for Planning Director use approval under CCZLDO 3.2.400 for a sand storage and sorting yard in the CBEMP segments 3-Water-Dependent Development Shorelands (3-WD) and 3-Non-Water-Dependent Shorelands (3-NWD). Pursuant to CCZLDO Section 3.2.400 "Uses Not Listed", the Planning Director may determine a proposed new use is similar and not more obnoxious or detrimental to the public health, safety, and welfare as other uses listed in the respective zoning district without amending the CCZLDO as described in CCZLDO Article 1.2. The Planning Director finds that the proposed use of a sand storage and sorting yard is similar in use to a log storage/sorting yard which is permitted subject to an administrative conditional use in both the 3-WD and 3-NWD zoning segments of the CBEMP listed in Sections 4.5.241 and 4.5.242.02 of the CCZLDO. Therefore, the sand storage/sorting yard is subject to the same provisions as the log storage/sorting yard within the 3-WD and the 3-NWD CBEMP segments.

*PLEASE NOTE - Decisions are subject to requirements and conditions stated in the staff report.

The application(s), all documents and evidence in the record, including the staff report, and the applicable criteria are available for inspection at the Planning Department, Coos County Courthouse Annex, 290 N. Central Blvd., Coquille, Oregon. You may purchase copies of these documents for a fee of 50 cents per page.

Pursuant to Article 5.8 of the CCZLDO, any person who is adversely affected or aggrieved by these decisions may appeal to the Coos County Hearings Body within 15 days of the date this notice of decision is mailed by filing a written "NOTICE OF APPEAL" and the required filing fee with the Planning Director. This means appeals filed after 12 noon on June 9, 2008, are not timely and will not be considered. These decisions will not be final until the period for filing an appeal has expired. These decisions cannot be appealed directly to the Land Use Board of Appeals under ORS.197.830. For detailed information about the appeal process, filing fees and additional information, please contact the Planning Department.

Additional information concerning the above-referenced item(s) may be obtained by contacting Jill Barzee, Administrative Aide, at (541) 396-3121 or 756-2020, extension 210.

COOS COUNTY PLANNING DEPARTMENT



Jill Barzee, Administrative Aide

Dated this 23rd day of May, 2008

COOS COUNTY PLANNING DEPARTMENT

Coos County Courthouse Annex, 290 N. Central
Coquille, Oregon 97423
(541) 396-3121 Ext. 210 Fax (541) 396-2690

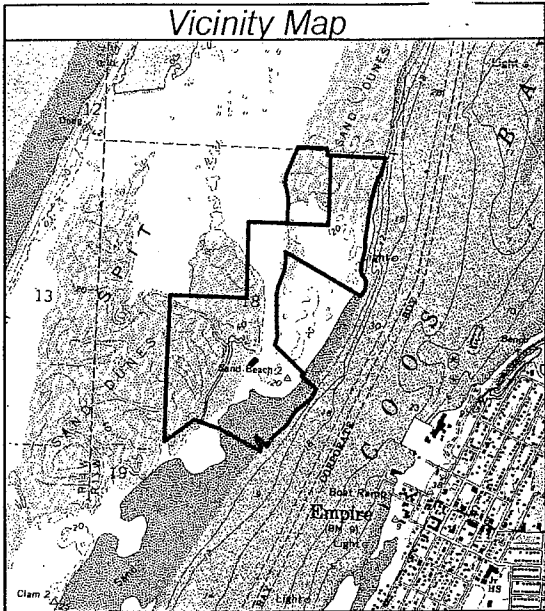

File Number: ACU-08-10 / CL-08-01

Applicant: Oregon International Port of Coos Bay
PO Box 1215
Coos Bay, OR 97420

Location: T25 R13 Sec.18 TL's 100, 200

Proposal: Storage & sorting of dredged & excavated sand

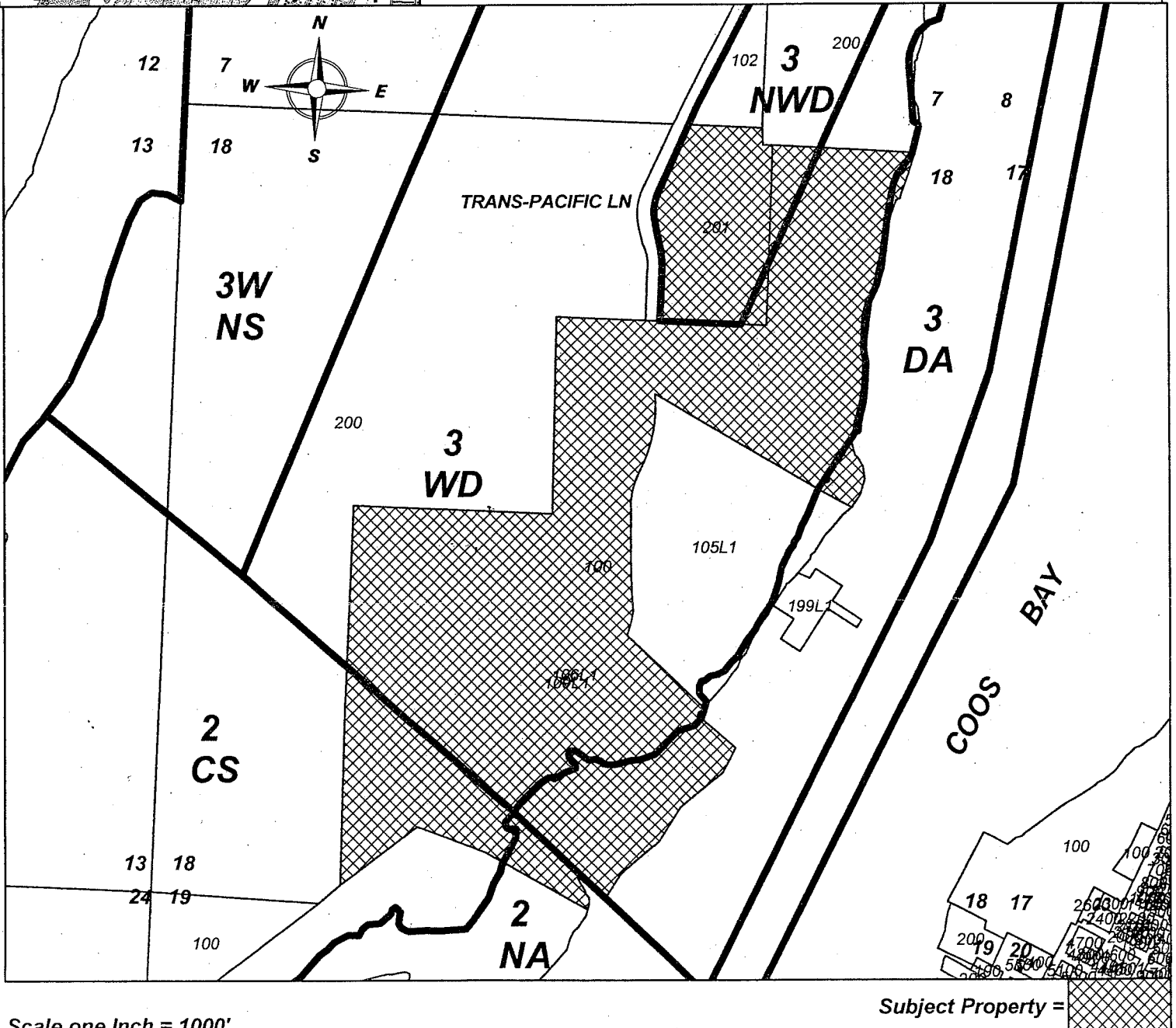

Scale one Inch = 1000'

Subject Property = [Cross-hatched pattern]